

PLANS: Open Base

INSPIRATION: Pottery Barn Printer Collection



Open Base – Basic Collection

Inspired by Pottery Barn's Printer's Collection, the open hutch is easy to build and works with the rest of the collection. Like Pottery Barn's Printer's Collection, these plans call for pine boards or pine sanded plywood.



Shopping List

Quantity	Description	Notes or Substitutions
½ Sheet	¾" Plywood or MDF (Plywood for staining, MDF for painting)	Edge banding will conceal plywood edges.
1	¼" Plywood, ¼ of a sheet	Can use paneling, beadboard, wainscoating, mdf, or most any other sheet goods.
1	16" ¾" x ¾" Nosing, Edging or Beading	
1	16" 2 ¼" Base Moulding	
1	1x2	30" Length is all you need
	Wood Glue	
	Shelf Pins if desired	
	1 ¼" Coarse Thread Self Tapping Pocket Hole Screws	
50	1 ¼" Finish Nails	
	120 Grit Sandpaper	
	Finishing Supplies	Wood Filler, Pocket Hole Plugs, Paint, Stain, Varnish, etc

Tools

Measuring Tape, Square, Drill, Pocket Hole Jig (Kreg Jig), Hammer, Saw (if your hardware store isn't so kind to cut your boards for you), Finish Tools (Sanding Block, Paint Brushes, etc)

Cut List

Quantity	Board Description	Cut Length	Cut Piece
1	1x16	29 1/4"	Sides
1	1x16	16"	Top
3	1x16	14 ½"	Shelves
1	¼" Plywood	16" x 30"	Back
1	¾" Nosing, Edging or Beading	16"	Crown
1	2 ¼" Base Moulding	16"	Base Moulding
2	1x2 Pine Boards	14 ½"	Trim

General Instructions

Work on a clean, level surface. Use safety precautions including eye and ear protection. Measure and mark out all joints prior to fastening. Drill all pocket holes before beginning assembly. Use glue on all permanent joints. Check for square after each step. Clamp joints to ensure the most accurate joint when fastening. Cut all boards or have your hardware store make cuts for you. Only use straight boards, free of cracks, warping and kiln dried.

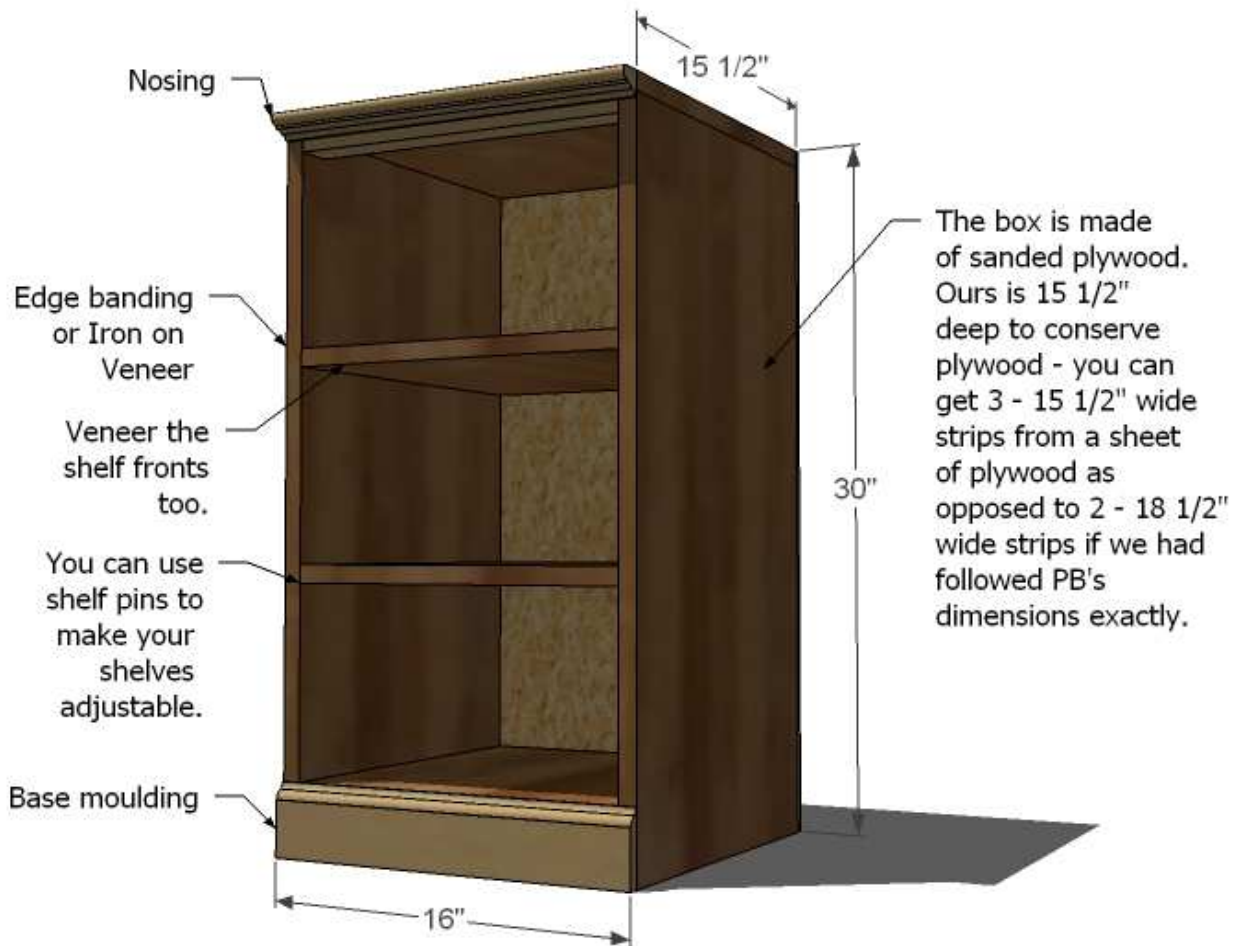

Step 1: Rip Plywood

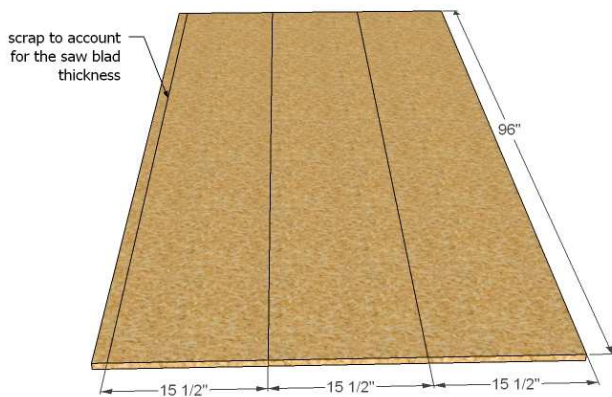

Have your hardware store rip plywood into 15 1/2" widths as shown in the diagram. You will be able to get 3 1x16s from a single sheet of plywood. **TIP:** Ask your hardware store to set the track saw 15 1/2" from the bottom, and rip your plywood horizontally, running the plywood through the saw as opposed to moving the saw to make sure you boards are all the same widths. Then cut your boards according to the cut list.

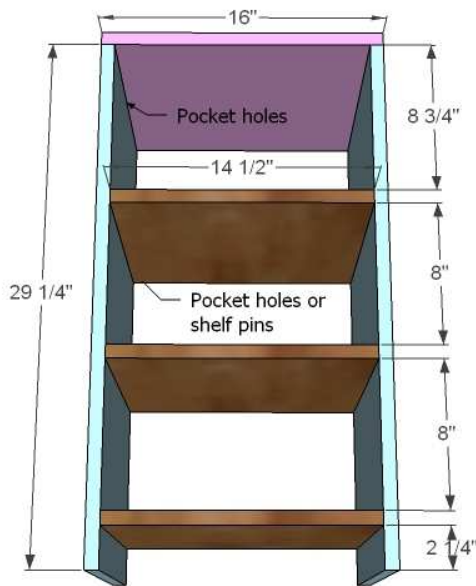

Step 2: Box

Drill pocket holes on the insides of the sides on the top. Also, if you are using shelf pins, drill shelf pin holes on the inside of the sides, with a drill bit set for the shelf pins. You can also make fixed shelves using pocket holes drilled on the underside of the shelves. Pocket holes will need to be set for 3/4" stock. Use 1 1/4" pocket hole screws to attach everything. And glue.

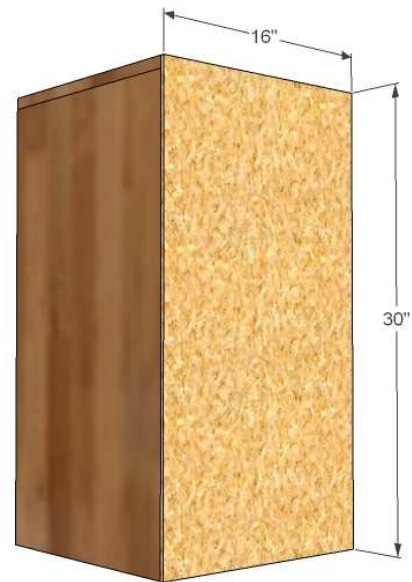

Step 3: Back

If you are building a whole suite, it would be easy to have your hardware store rip your back plywood into 16" widths too. This time, have them set the saw blade at 15 7/8". If your plywood is short a hair on the back, it won't matter. Use glue and 1 1/4" nails to attach the back. Make sure you nail into any fixed shelves too.

Step 4: 1x2 Trim

Attach the 1x2 trim pieces, flush to the front, as shown in the diagram. Use 2" finish nails from the outsides too, or pocket holes from the undersides.



Step 5: Moulding

You may wish to apply edge banding for a stained finish to any exposed plywood edges at this step. The edge banding is a veneer that finishes plywood edges and is very easy to do and effective (and inexpensive).

Attach the moulding to the base as shown in the diagram. Use glue and 2" finish nails.

Step 6: Finishing

Fill all pocket holes and nail holes with plugs or wood filler. Let dry. Fill again with wood filler. Let dry. Sand with 120 grit sandpaper.

Prime and paint or stain as desired. Add a top clear coat for stain or flat paints to preserve your finish if desired.

