

Fancy Jewelry Box Dimensions

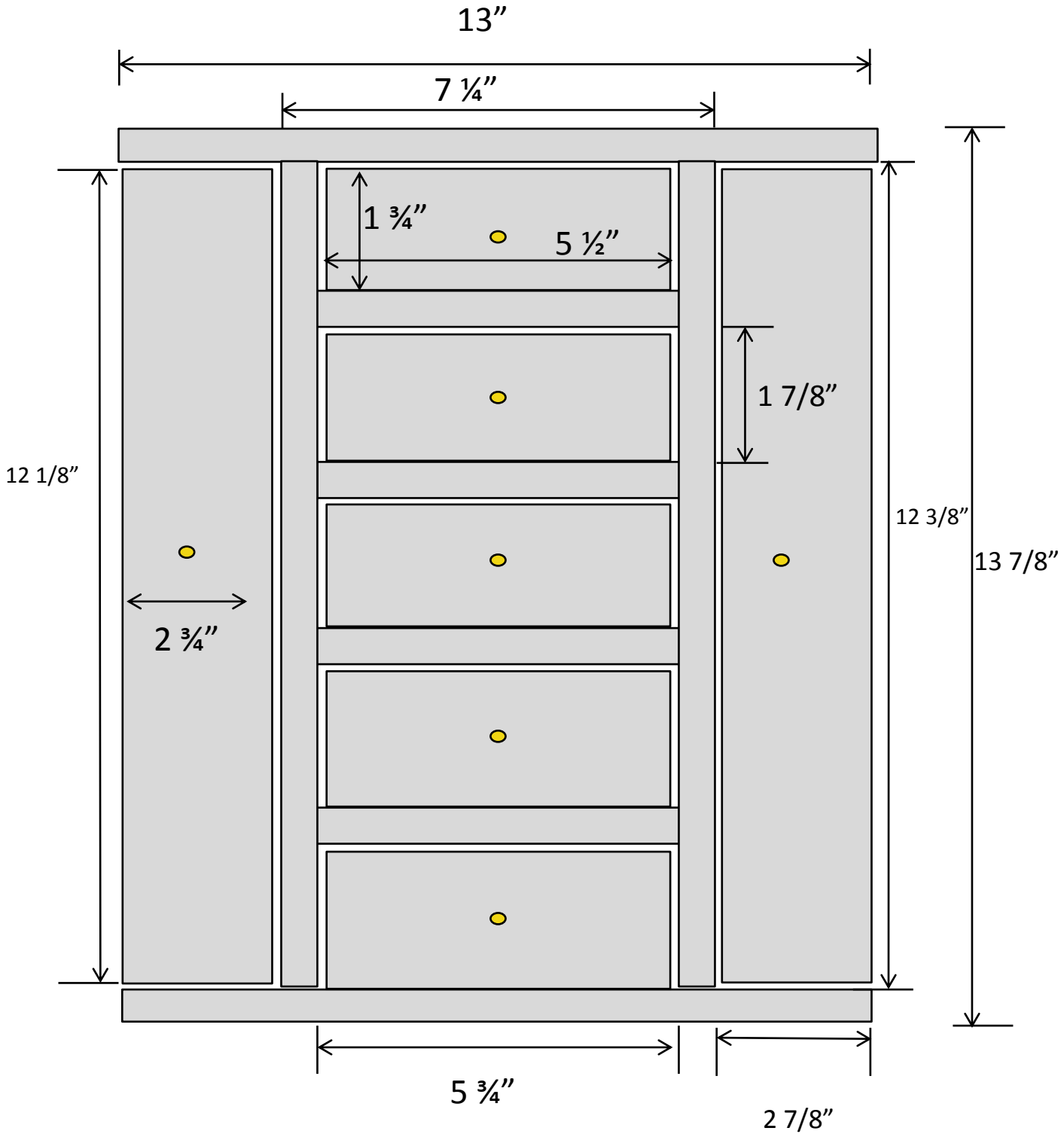

Shopping List

1 pc 1x8x8

1 pc 1x3x6

2 pc 1x2x6

1 pc 1/2" x 1 1/2" x 2' craft board

1 pc 1/2" x 2 1/2" x 2' craft board

1 pc 1/4" x 2' x 2' hardwood plywood

1.5 oz pkg 1 1/4" wire nails

(or substitute 3/4" shoulder hooks - about 24)

4 2-packs of 1" unfinished knobs

2 sets flat hinges (about 1 1/2" x 3 1/2")

1 1/4" finish nails

1" finish nails

Wood glue

Wood filler/putty

Sandpaper

Paint or stain of your choice

Optional

Wax for bottoms of drawers and shelves

Felt/fabric/paper for box bottom and drawer/door lining

Magnet catches for doors

Box Cut List

1x8:

- 2 pc @ 13" (top & bottom)
- 2 pc @ 12 3/8" (tower sides)
- 4 pc @ 5 3/4" (shelves)
- 2 pc @ 1 7/8" (spacers)

1x2:

- 10 pc @ 5 1/2" (drawer front & back)
- 10 pc @ 5 3/4" (drawer sides)
- 2 pc @ 5 3/4" (door bottoms)

1x3:

- 2 pc @ 5 3/4" (door tops)
- 4 pc @ 12 1/8" (door front/back)

1/2" x 2 1/2" craft board

- 2 pc @ 5 3/4" (upper insides of doors)

1/2" x 1 1/2" craft board

- 2 pc @ 5 3/4" (lower insides of doors)

1/4" hardwood plywood:

- 1 pc @ 7 1/4" x 13 7/8" (back)
- 5 pc @ 5 1/2" x 7 1/4" (drawer bottoms)
- 2 pc @ 7 1/4" x 12 1/8" (door outsides)

Diagram for cutting $\frac{1}{4}$ " plywood from 2' x 2' piece:
 Cut the $7\frac{1}{4}$ " strips first, then cut them down as shown

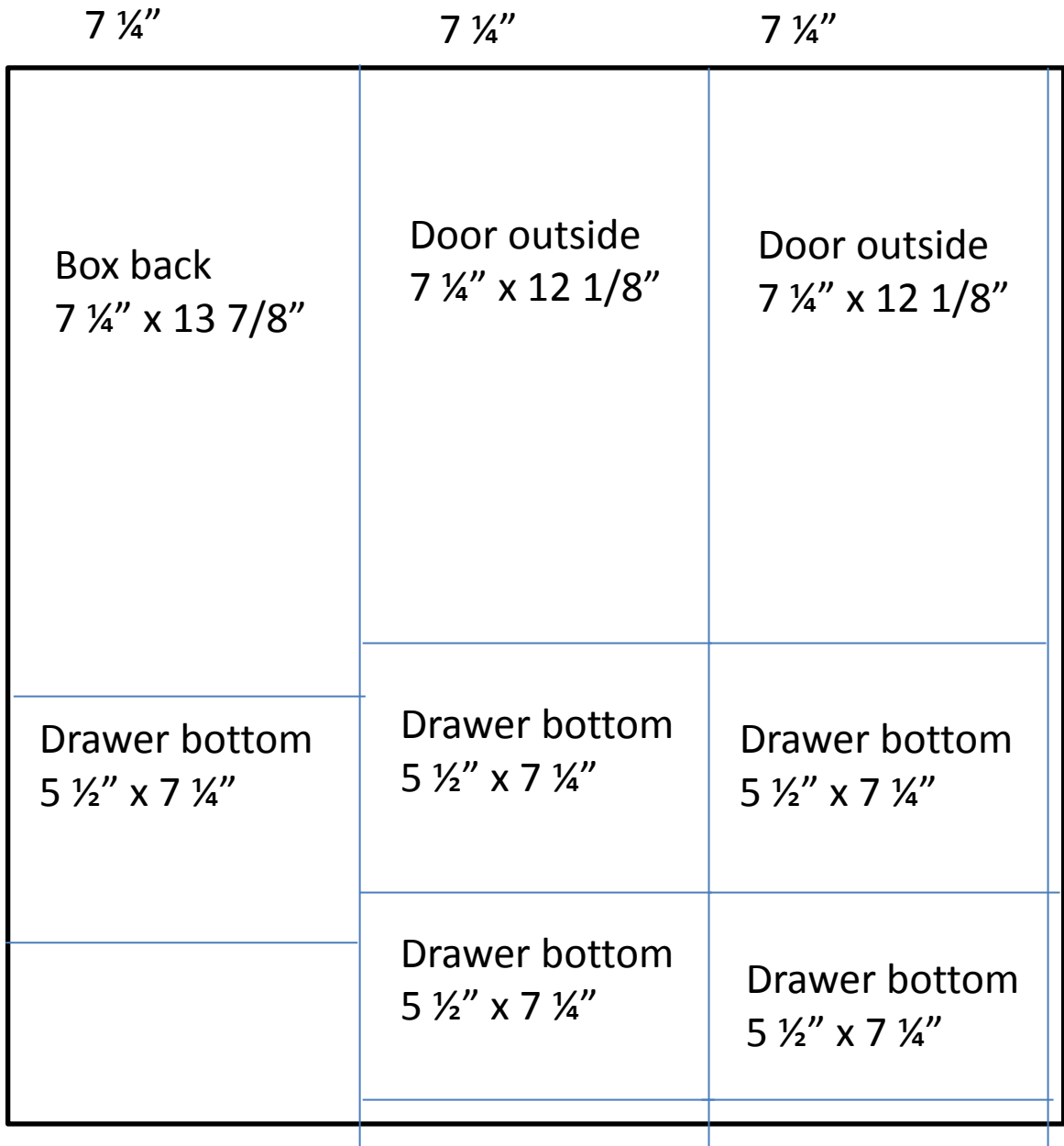

1. Mark your boards where the sides meet the top and bottom, $2\frac{7}{8}$ " from outside edges

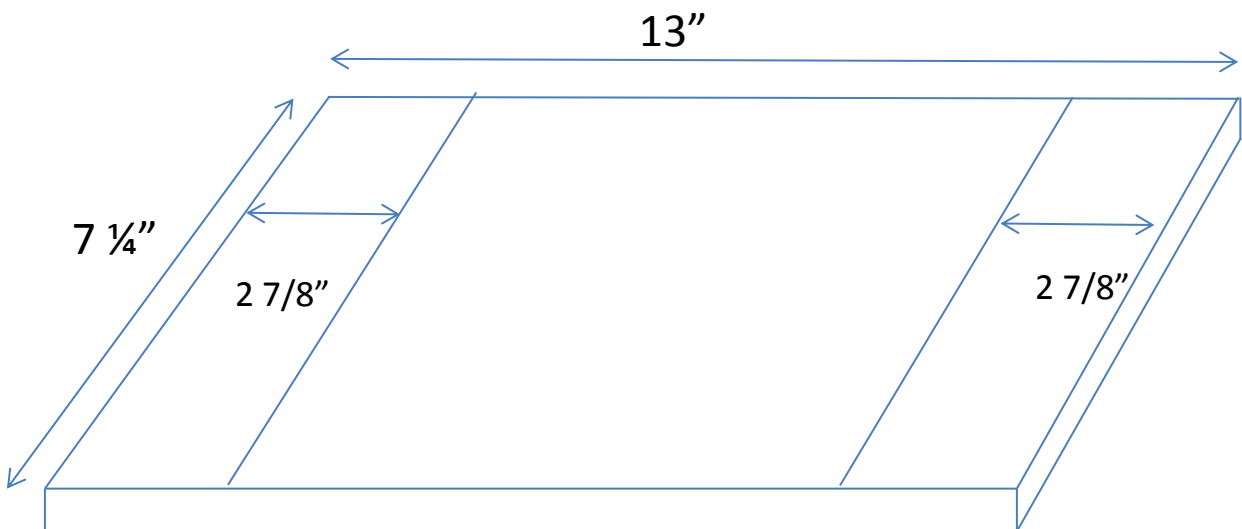
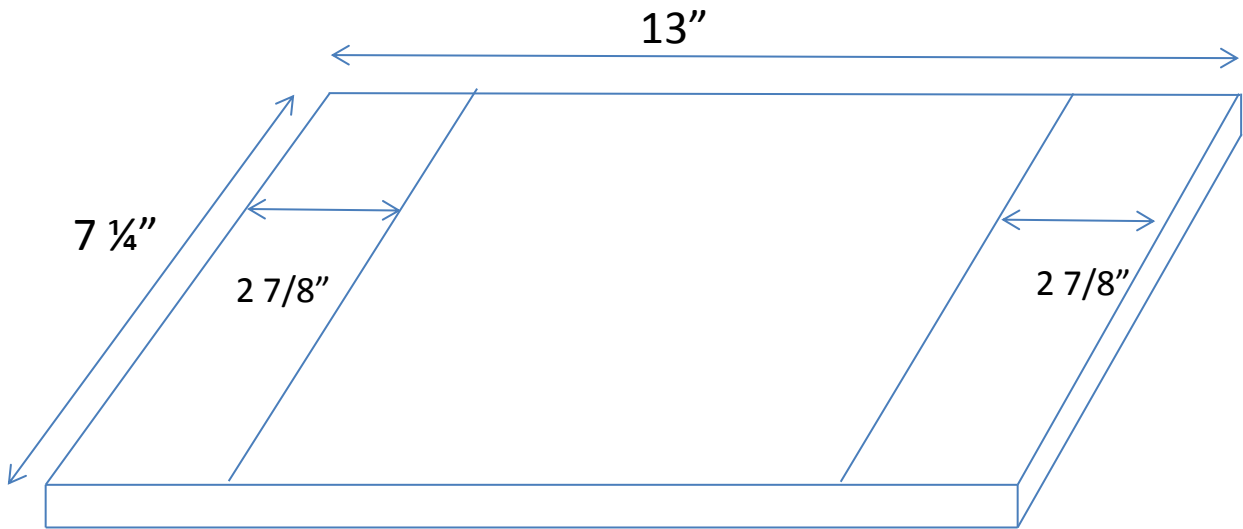

2. Attach sides to bottom, match with lines to leave $2\frac{7}{8}$ " overhang on both sides. Use glue & $1\frac{1}{4}$ " finish nails.

3. Attach top to sides, making sure sides match with the lines to leave $2\frac{7}{8}$ " overhang on both sides. Use glue & $1\frac{1}{4}$ " finish nails

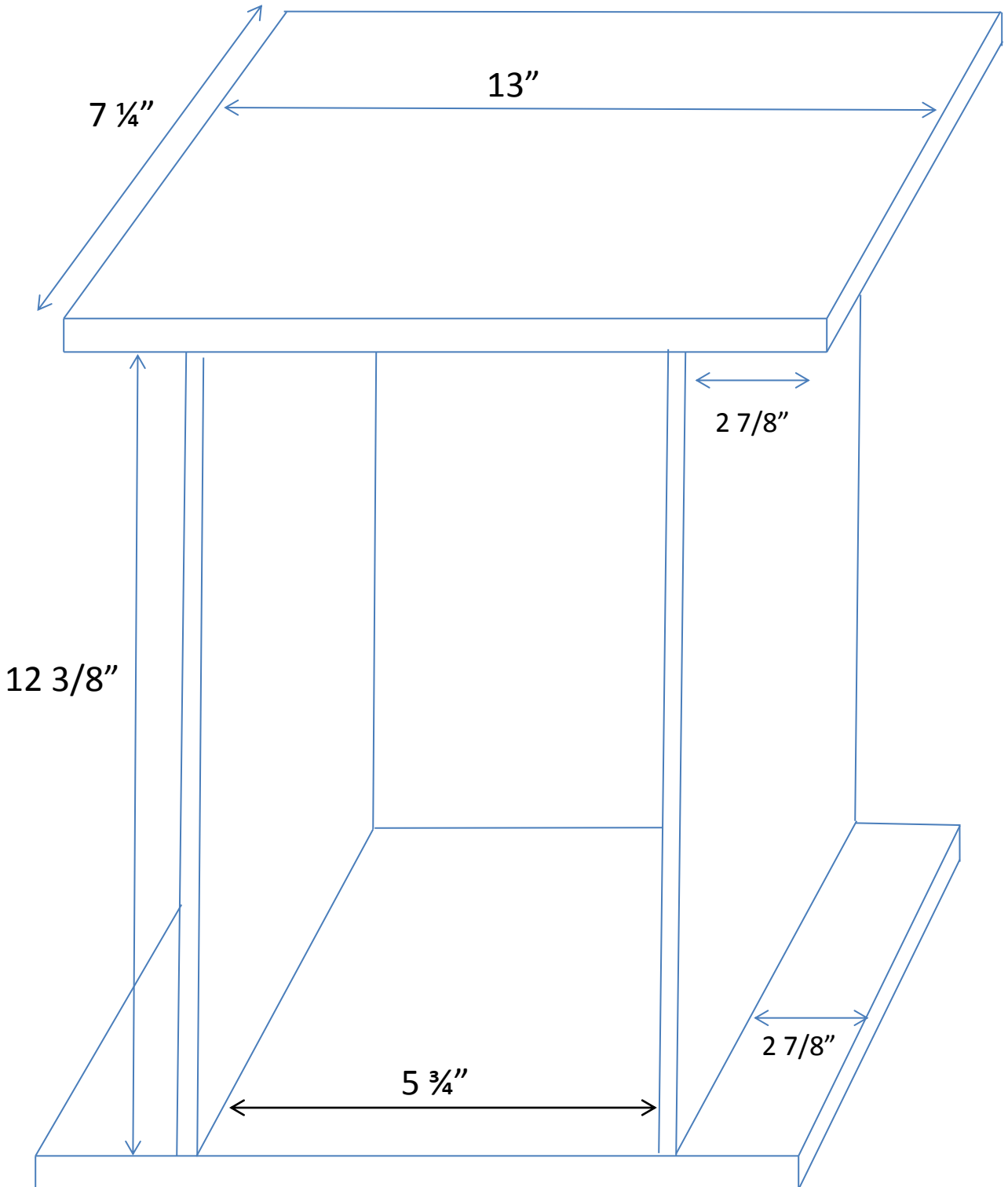

4. Attach shelves to sides, using $1\frac{7}{8}$ " spacer to make sure shelves are spaced the same in between all the way up. Start at the bottom and repeat for each shelf. Use glue & $1\frac{1}{4}$ " finish nails.

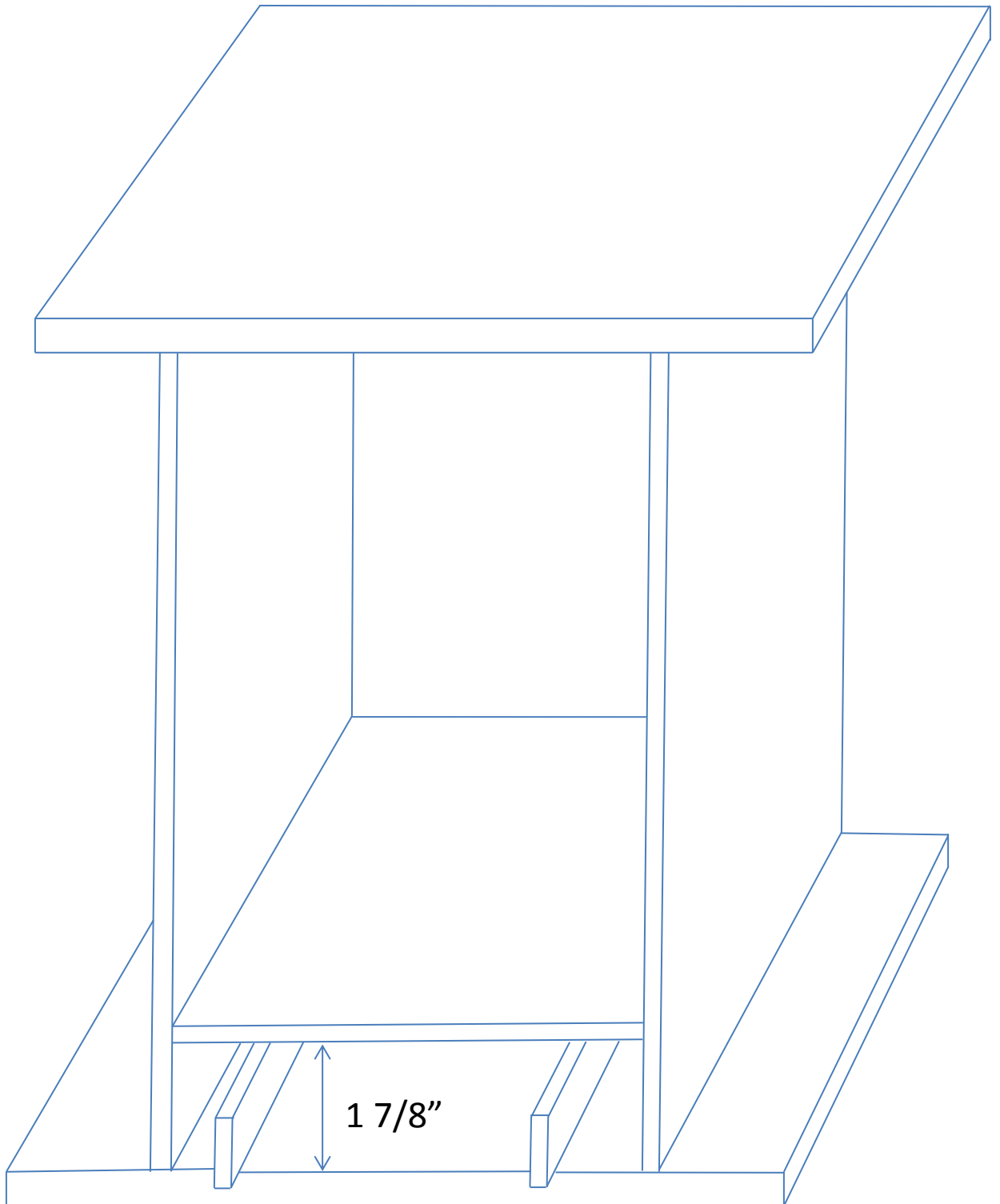

4a. Repeat step 4 for each shelf, using spacers to keep everything evenly spaced.

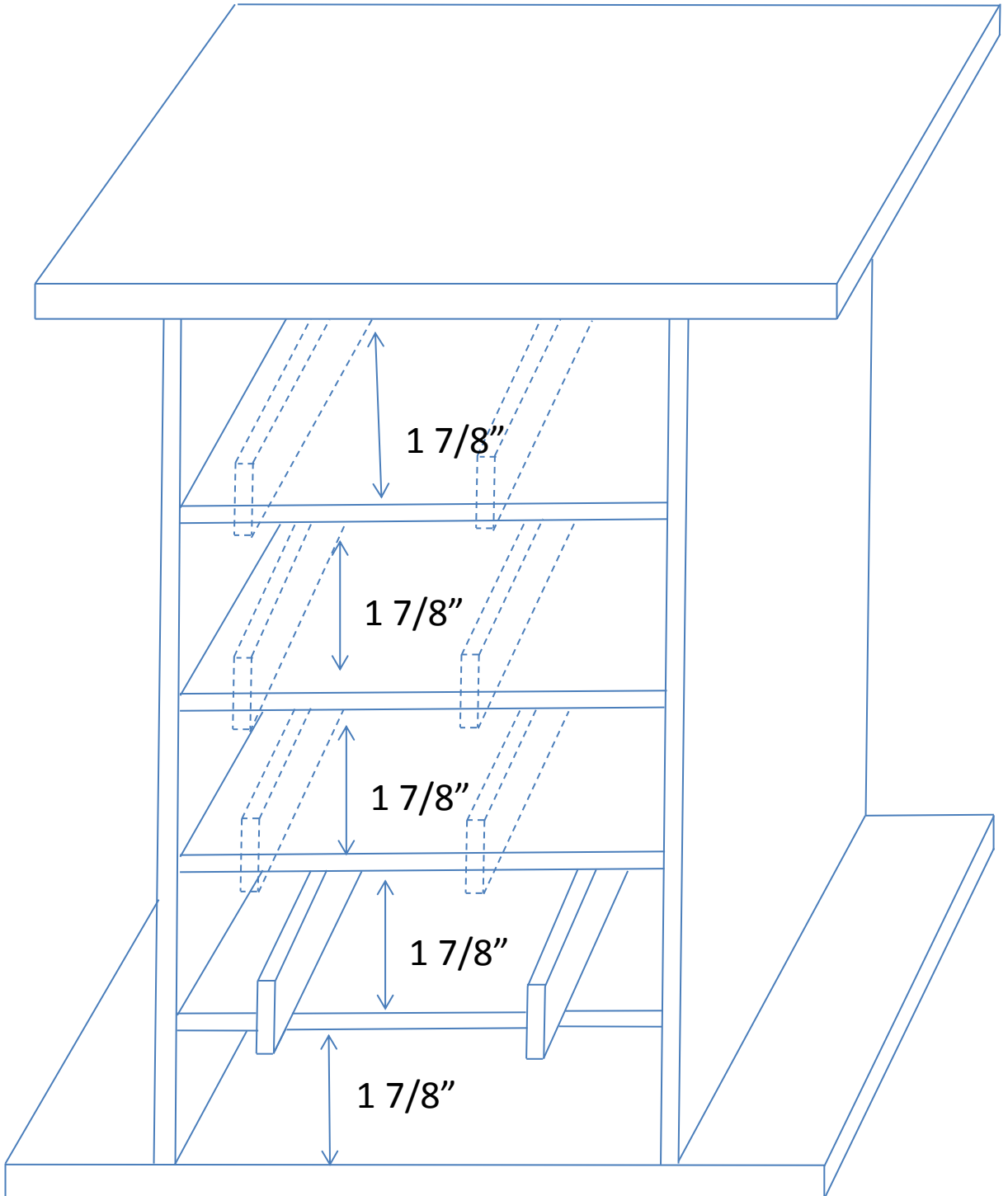

5. Attach back to box. Back only covers shelves and sides, not the overhangs. Use glue and 1" finish nails.

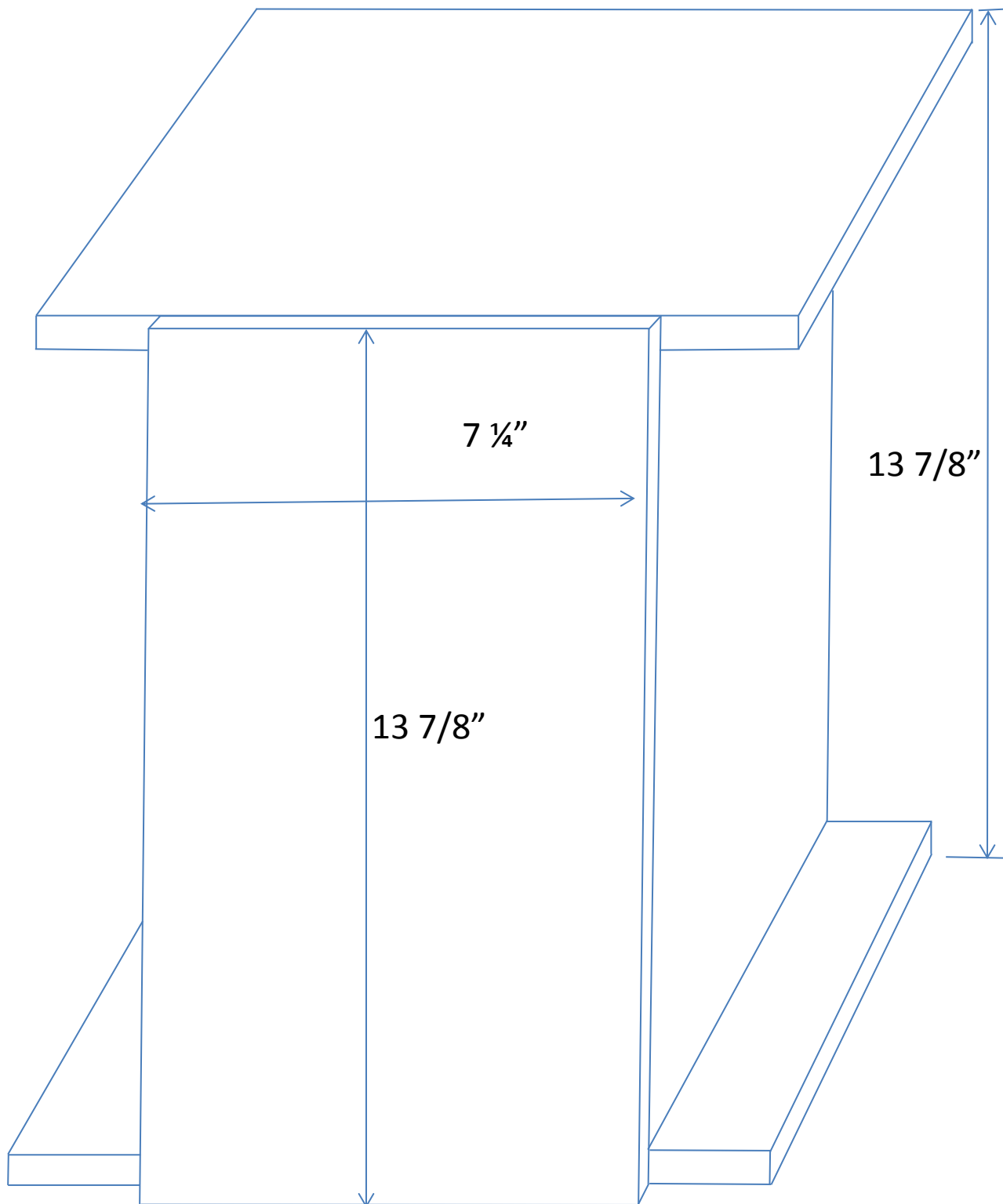

6. Measure and mark drawer fronts for knobs/pulls, and drill holes in fronts

7. Attach side to drawer fronts and backs. Use glue & 1 1/4" finish nails.

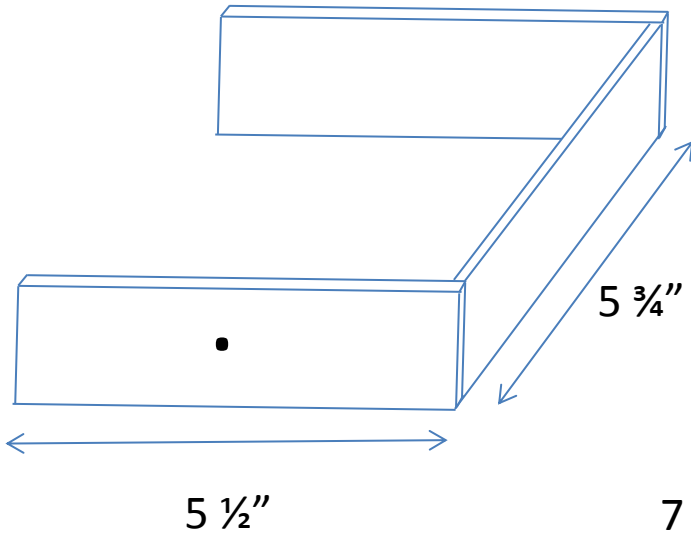

8. Repeat for other sides. Use glue & 1 1/4" finish nails.

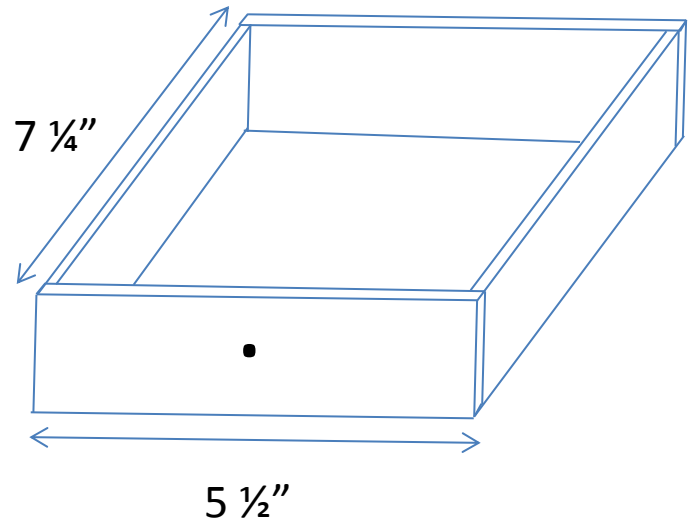

9. Attach drawer bottoms (5 drawers) Use glue & 1" finish nails.

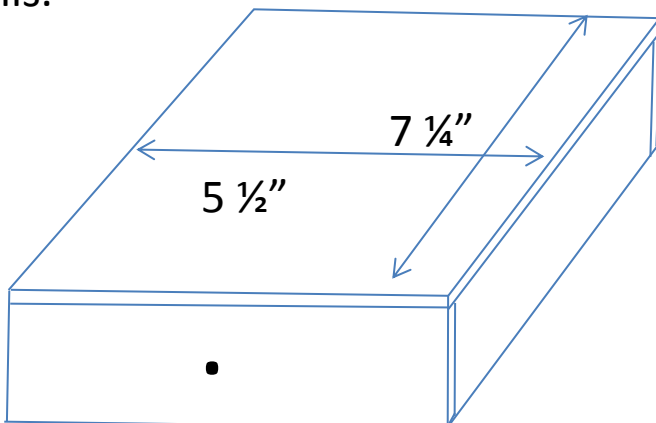

10. Attach door front to top & bottom (2 doors). 1x3 goes at the top and 1x2 goes at the bottom. The 1x2 should be flush with one side, as shown in diagram.

11. Repeat with door back, (2 doors), keeping 1x2 flush with one side as shown. Use glue & 1 1/4" finish nails.

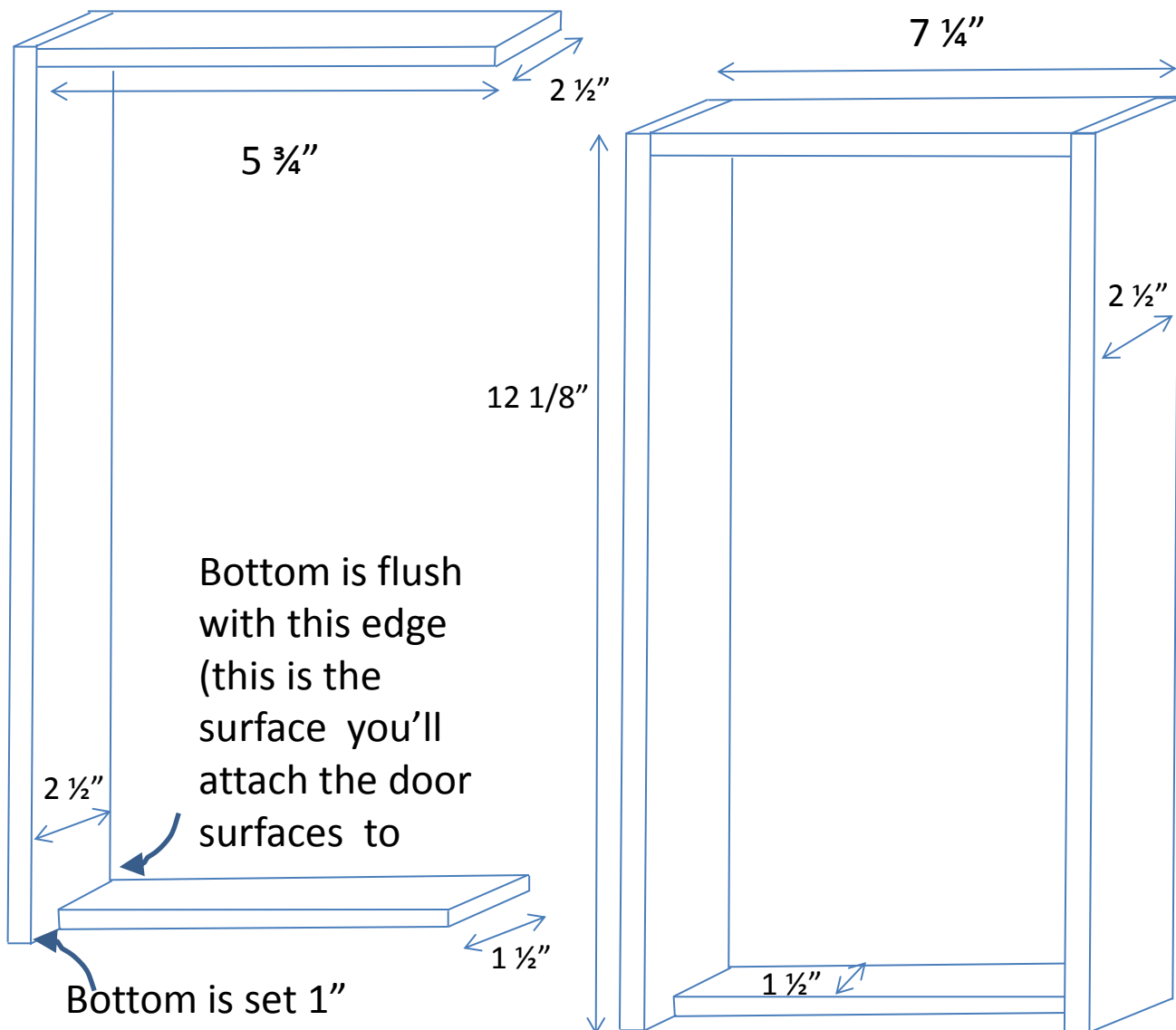

Bottom is set 1" in from this edge – this will be on the inside of the door

12. Attach door surface to door frame (2 doors) Use glue & 1" finish nails.

Note: These doors should be mirror images – the 1x2 surface flush with the edge is the one to attach the door surfaces to.

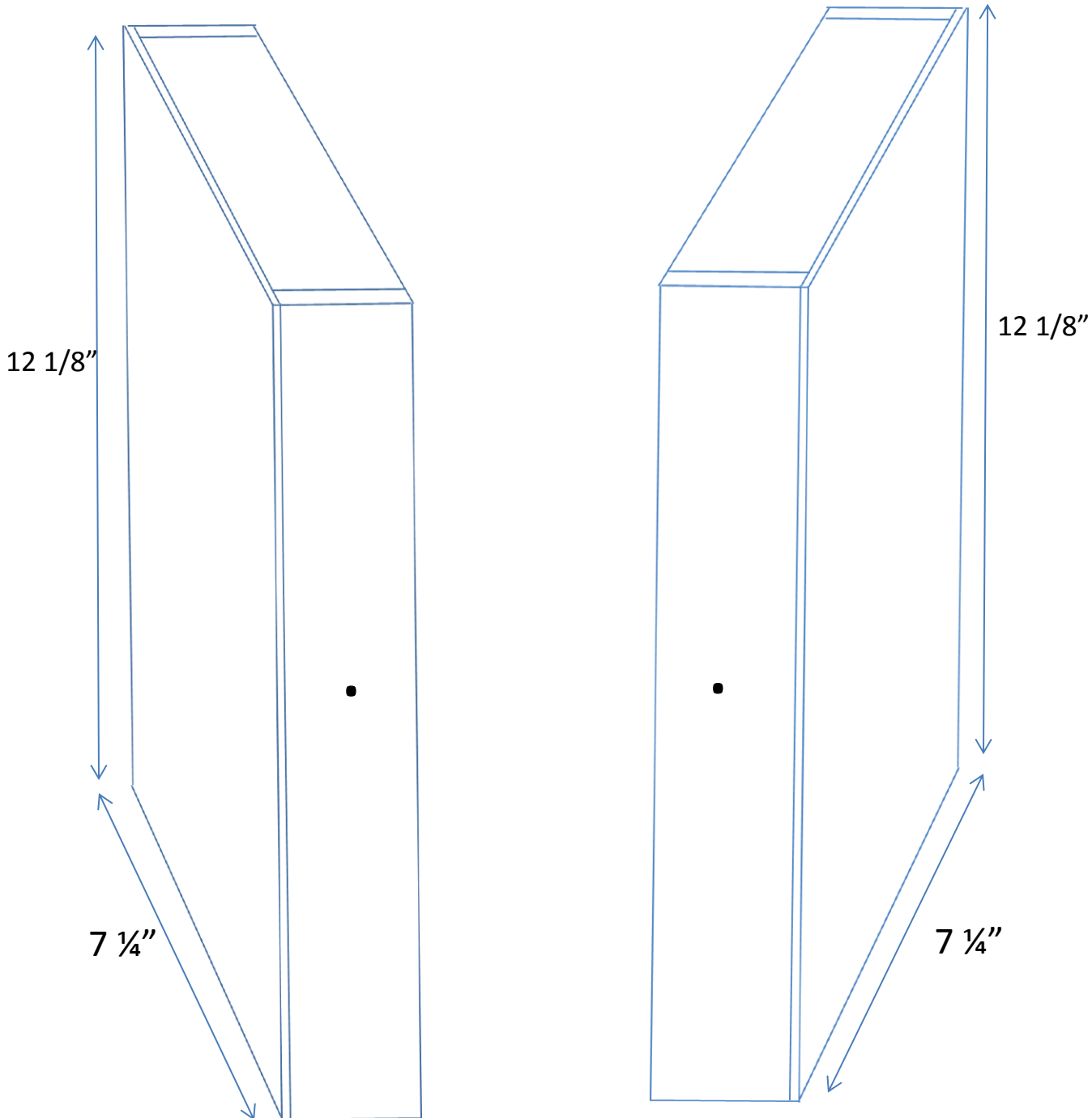

13. Attach piece of $\frac{1}{2}$ " trim to inside bottom of both doors, on top of 1x2, with front edges of bottom flush with this piece, as shown. Use glue & $1\frac{1}{4}$ " finish nails.

14. Drill holes for knobs in fronts. Note they are mirror images of each other, to ensure correct placement of the knobs on the fronts

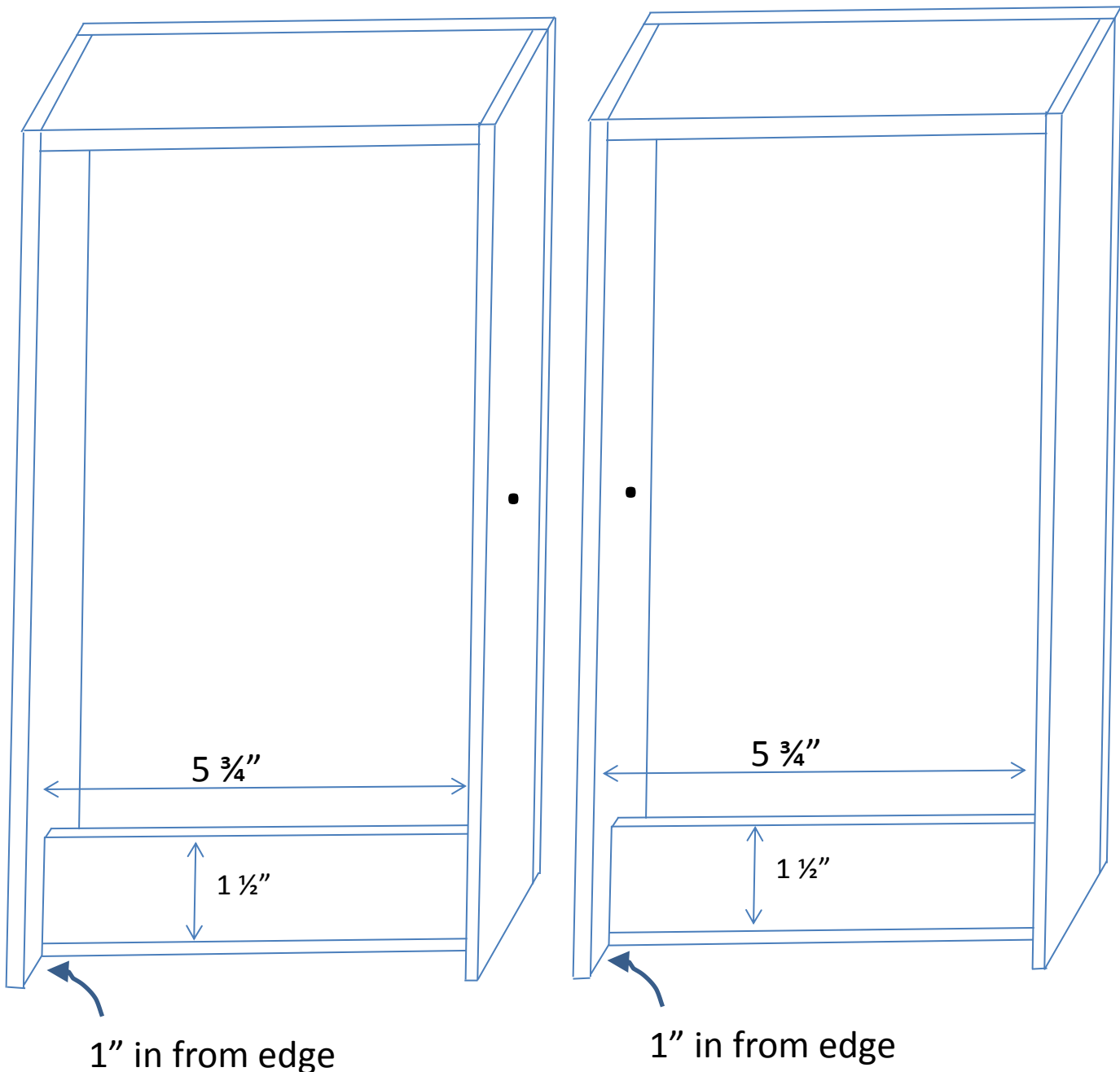

15. Attach piece of 1/2" trim to inside top of doors as shown. Glue and clamp this piece in place.

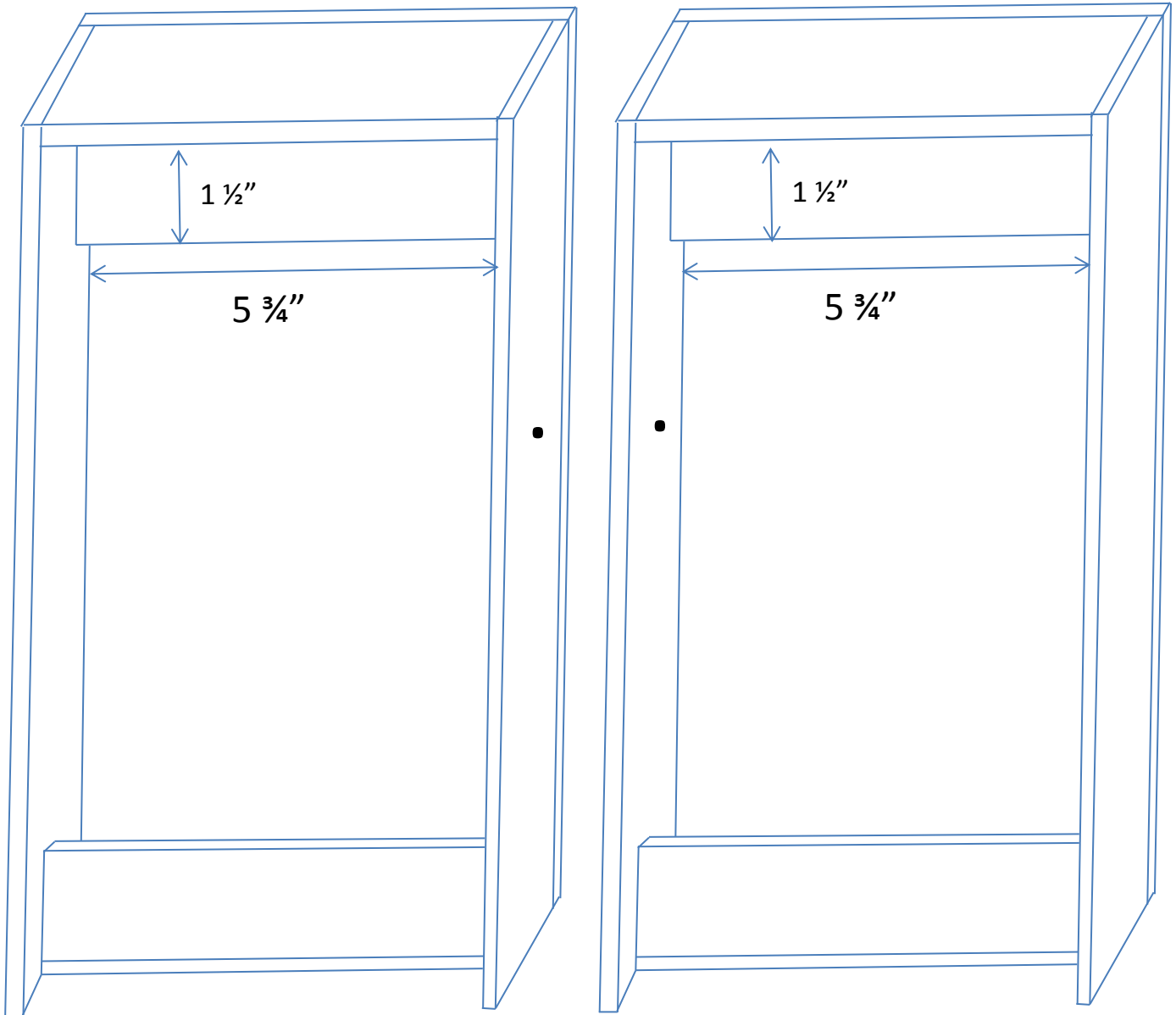

16. Fill nail holes and edges with wood filler and allow to dry.

17. Sand all parts and wipe down

18. Apply desired finish

19. Mark where hooks or nails will go on box sides, and attach.

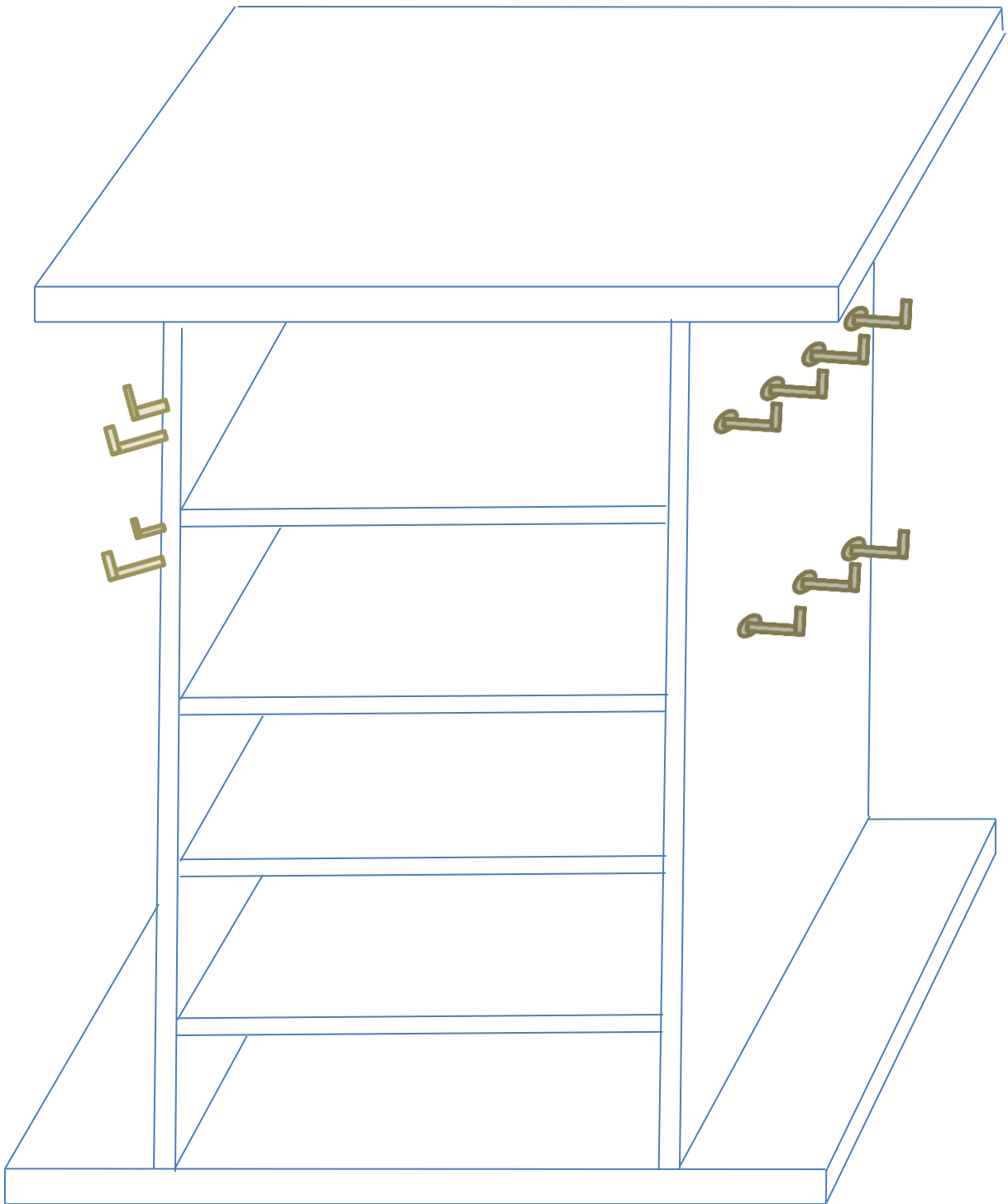

20. Mark where hooks or nails will go inside of upper doors, and attach to the craft board.

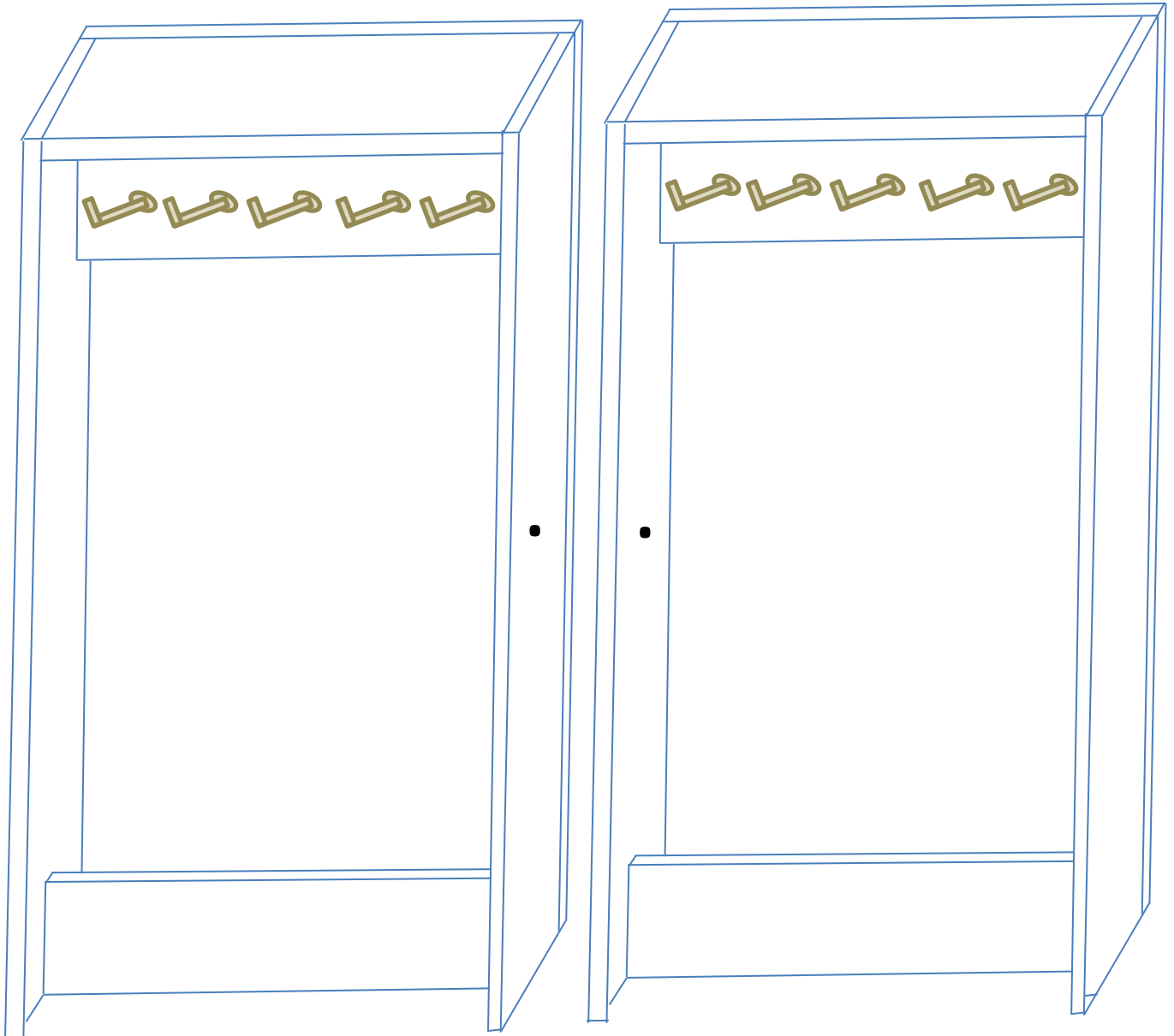

21. Attach hinges to back of box on both sides (2" down from top, and 2" up from bottom)

22. Shim doors into place, leaving 1/8" at top and bottom, and attach hinges to back of doors

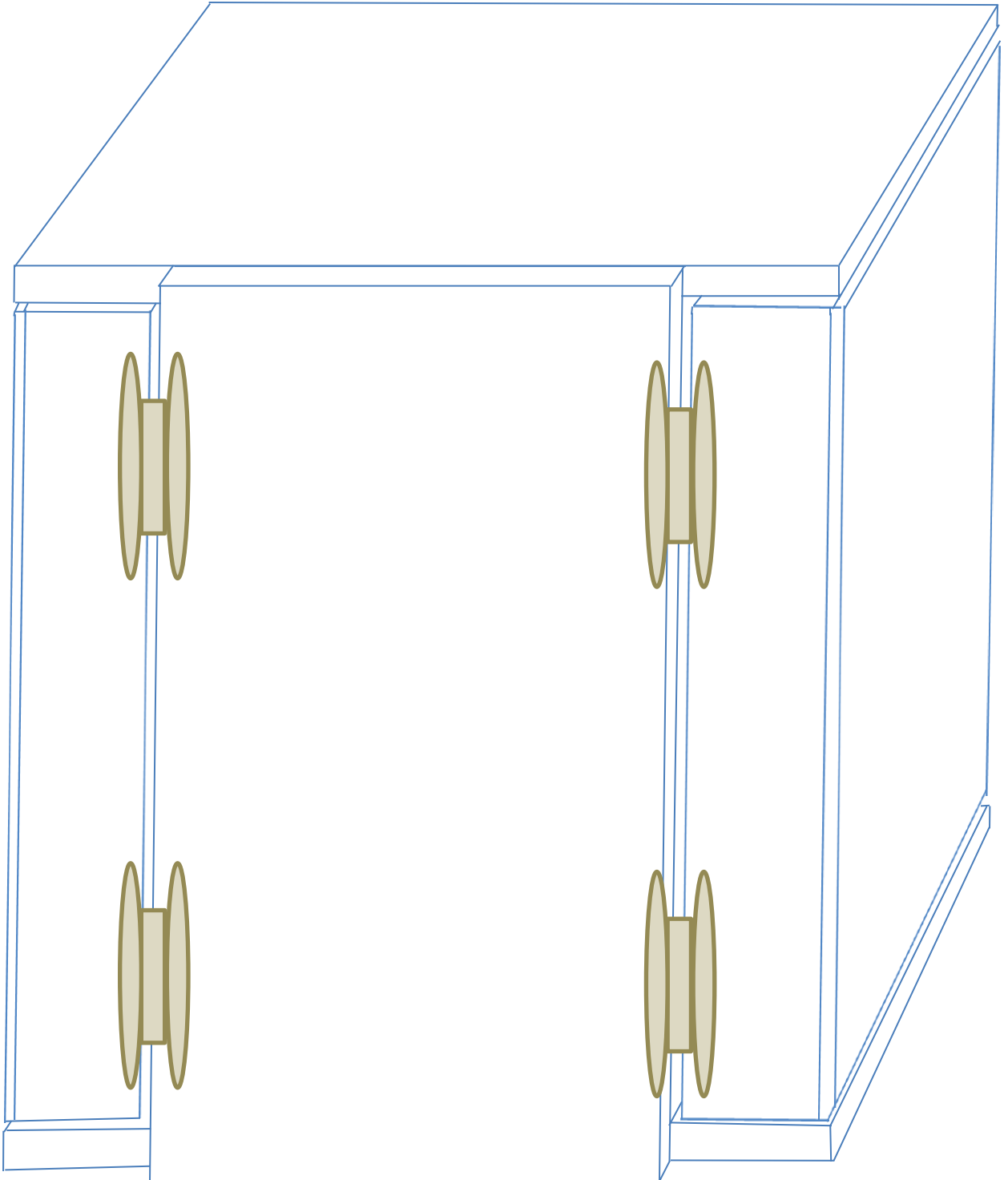

23. Front open view of jewelry box without drawers in place.

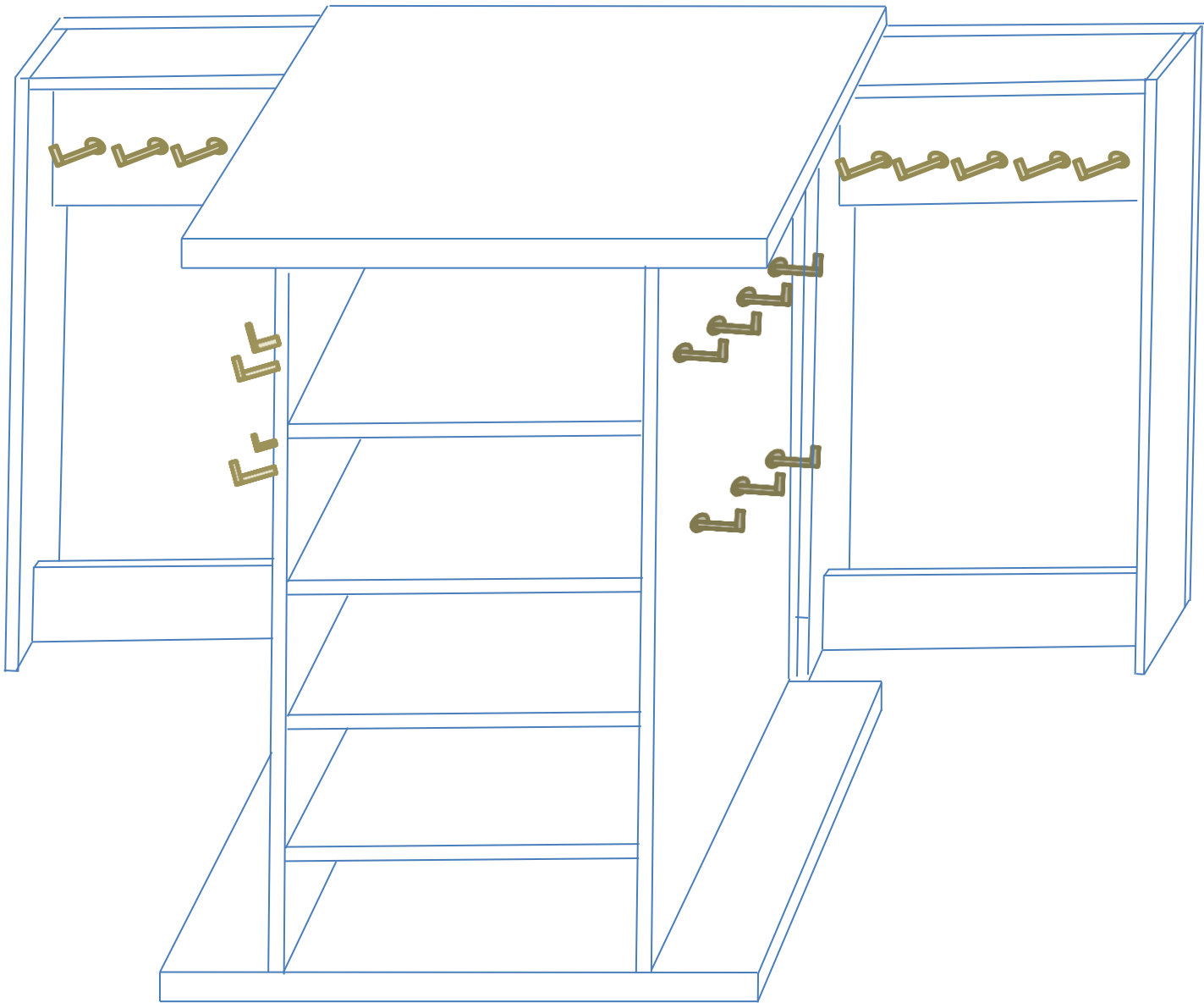

24. Attach knobs to doors and drawers.

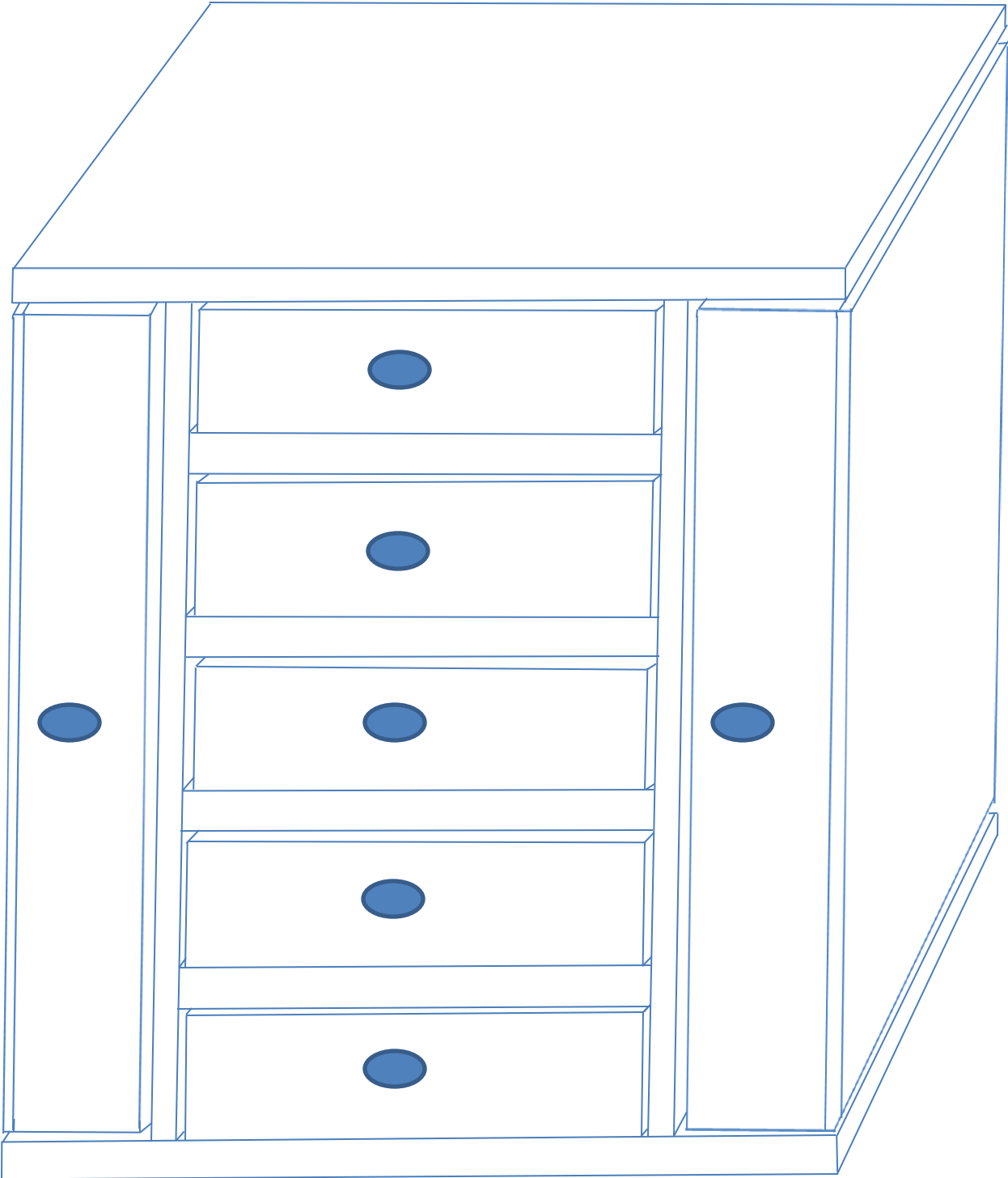

Optional Steps:

(cost for these is not included in the breakdown)

Add magnet catches to keep doors closed.

Attach some felt (sticky back is easiest) to the bottom of the box.

Apply some wax to the bottoms of the drawers for easy sliding.

Line drawers and insides of doors with paper, felt or fabric.